

At Summit Point, we offer the quiet lifestyle of a quaint community with all the amenities you're looking for.

Get cozy in front of your wood burning fireplace, offered in all of our 1 and 2 bedroom apartment homes!

With easy access to I30 and 635, you're just minutes from endless shopping, restaurants, schools, and churches.

Summit Point is within walking distance to Eastfield Community College.



## Interior Amenities

- Frost-free Refrigerators w/Ice Maker
- Garbage Disposals & Dishwashers
- Washers & Dryers Provided\*
- Mirrored Wardrobe Closet\*
- Walk-in Closets
- Vaulted / High Ceilings
- Ceiling Fans
- Fireplaces\*

## Exterior Features

- Complimentary Roadside Assistance
- Patios or Balconies
- Assigned Parking
- Outside Storage
- Beautiful Swimming Pool
- 24-hour Emergency Maintenance
- Professionally Landscaped Grounds
- Pet Friendly\*\*

\* In Select Apartment Homes

\*\* Limited Breed Restriction applies

3720 Oates Drive  
 Mesquite TX 75150  
 Office: (972) 278.0200  
 Fax: (972) 681.4009

[summitpoint@monticelloproperties.com](mailto:summitpoint@monticelloproperties.com)  
[mysummitpoint.com](http://mysummitpoint.com)

# Summit Point Apartments



3720 Oates Drive  
 Mesquite TX 75150



# Summit Point Apartments

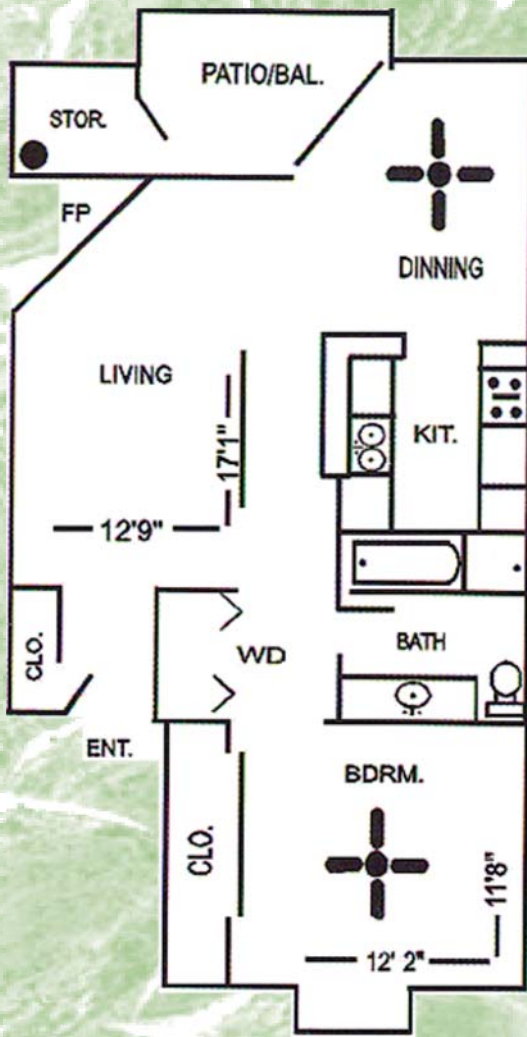

1 Bdrm / 1 Bath 806 Sq. Ft.

RENT \_\_\_\_\_

DEPOSIT \_\_\_\_\_

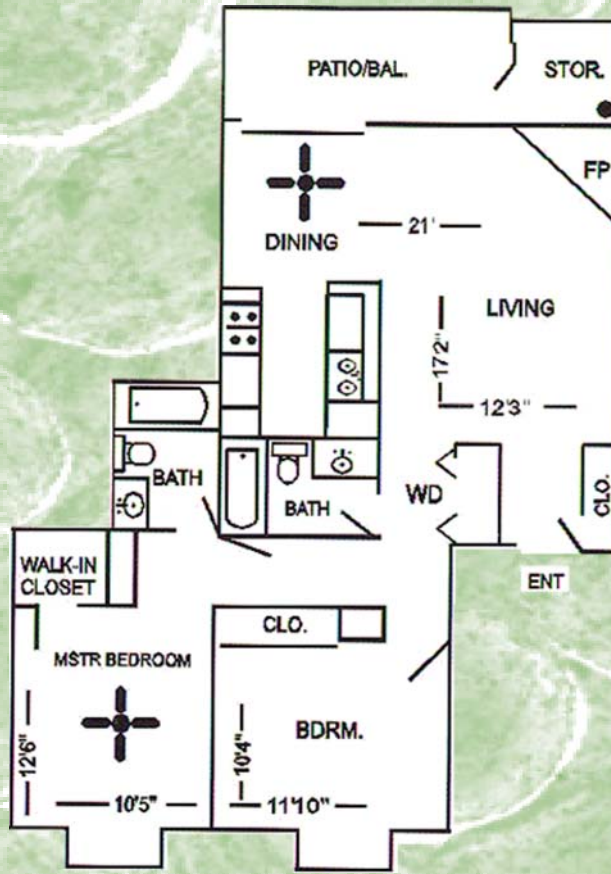

2 Bdrm / 2 Bath 951 Sq. Ft.

RENT \_\_\_\_\_

DEPOSIT \_\_\_\_\_

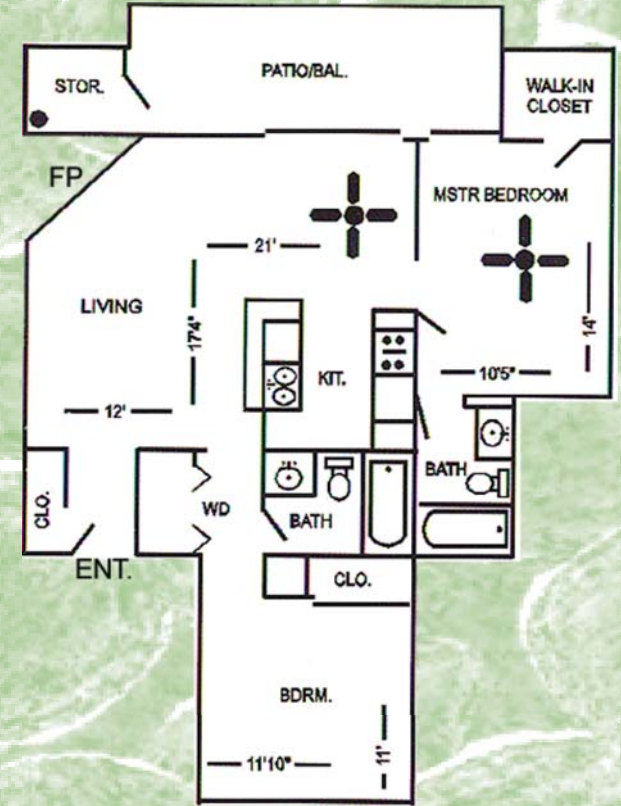

2 Bdrm / 2 Bath 1,014 Sq. Ft.

RENT \_\_\_\_\_

DEPOSIT \_\_\_\_\_

3720 Oates Drive  
Mesquite TX 75150  
Office: (972) 278.0200  
Fax: (972) 681.4009

summitpoint@monticelloproperties.com  
mysummitpoint.com

All square footage is approximate